



# Ice Machine Cleaning & Sanitizing

HOSHIZAKI

DCM-270BAH(-OS)

The icemaker/dispenser must be cleaned & sanitized at least twice a year.

## Cleaning Prep:

- 1 Close the water supply line shut-off valve and dispense all the ice from the storage bin.
- 2 Move the **power switch** to **OFF**. Remove the **Louver & Air Filter**. Move the **control switch** to **DRAIN**.
- 3 Move the **power switch** to **ON**. Allow the icemaker to drain completely. Move the **power switch** to **OFF**.

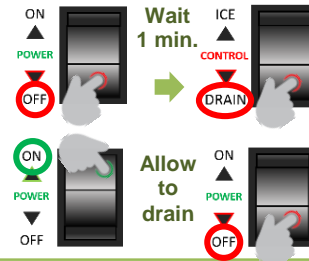
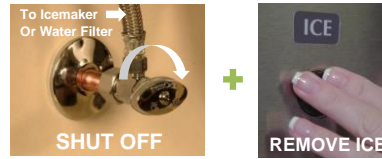

- ! ATTENTION! WAIT 1 MINUTE AFTER POWERING OFF,** to allow control board to de-energize. Otherwise there will be a long delay before ICE or DRAIN will activate.

If switch is left on DRAIN for more than 10 min., a 2-beep alarm will sound every 5 seconds.

## Cleaning:

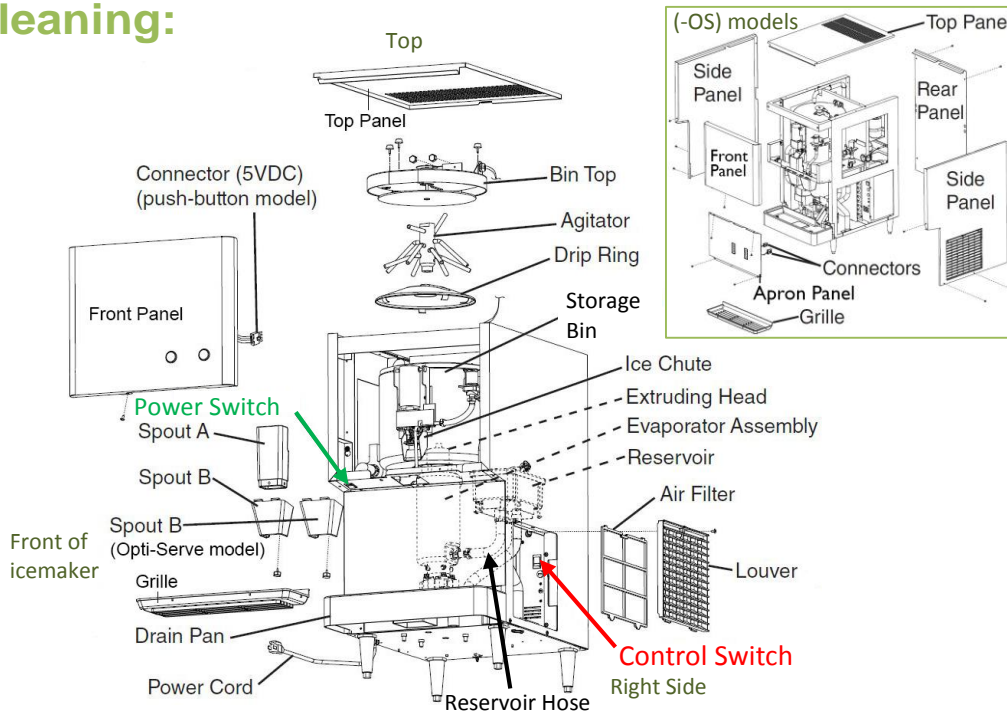

- 4 **Unplug** the icemaker from the electrical outlet. Dilute Hoshizaki Scale Away with warm water (see Table below). Remove the **Front Panel\***, **Top Panel**, **Bin Top**, **Agitator**, **Drip Ring**, **Grille**, and **Spouts A & B\*\***.

Pour cleaning solution over the **Extruding Head** until the **Evaporator Assembly** and the **Reservoir** are full and the solution overflows into the **Drain Pan**. Allow to soak for **10 minutes**.

\*Push-button models: Take care in disconnecting the button connector.

\*\*Use a 15mm socket with an extension to easily remove recessed thumb screws.

DCM-270BAH(-OS)	
Scale Away	6 fl. oz (177 ml)
Warm Water	1 gal. (3.8 l)



- 5 In bad water conditions, a more thorough soaking may be required. Follow Step 4, then place a clamp on the **Reservoir hose** that will block the flow to the **evaporator assembly**. Pour additional cleaning solution over the **Extruding Head** until the **Evaporator Assembly** is full. Allow to soak. Otherwise, continue to Step 6.



↳ continued on the back...

## ! ATTENTION!

**Do not** leave icemaker unattended when panels are off

**AMMONIA  
Cleaners**



## Sanitizing:

- Dilute 5.25% chlorine bleach<sup>‡</sup> with warm water (see Table below)

DCM-270BAH(-OS)	
Bleach	1.5 fl. oz (44 ml)
Warm Water	3 gal. (11.4 l)

<sup>‡</sup> Use bleach without additives.

- Pour the sanitizing solution over the extruding head until solution starts to overflow into the drain pan
- Allow to soak for 10 minutes
- Scrub all items with a nylon scouring pan, brushes, and sanitizing solution
- Rinse all items thoroughly with clean water
- Move **control switch** to ICE, replace the front panel
- Reassemble drip ring, agitator, bin top, grille, spouts A & B, and replace panels
- Plug in the icemaker
- Move the **power switch** to ON
- Make ice with the solution until it stops, dispose of ice
- Move the **power switch** to OFF
- Unplug the icemaker

6 Using a nylon scouring pad, nylon brushes, and cleaning solution scrub the **Storage Bin, Bin Top†, Agitator, Drip Ring, Grille, Spouts A & B, Ice Chute, and Drain Pan.**

† Be sure to keep the microswitch mounted on the Bin Top dry.



7 Remove the clamp (if installed in Step 5) from the **Reservoir** hose. Rinse all parts thoroughly with clean water before reassembling the **Drip Ring, Agitator, Bin Top, and Front & Top Panels.**

8 Move the **control switch** to **ICE**. *Plug* the icemaker into the electrical outlet. Move the **power switch** to **ON**. Make ice using the cleaning solution until it stops, dispose of ice. Move the **power switch** to **OFF**.



**! ATTENTION!** Icemaker might make noise/squealing when first started due to scale being removed from auger/evaporator. This is normal in bad water conditions and will subside after 20 min.

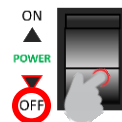

## Cleaning Rinse:

9 Move the **control switch** to **DRAIN**, and the **power switch** to **ON**. Allow the icemaker to drain completely.

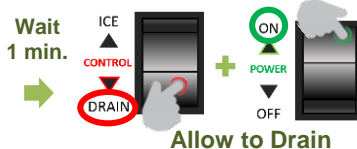

10 Move the **power switch** to **OFF**. *Unplug* the icemaker from the electrical outlet. Remove the **Front Panel, Top Panel, and Bin Top.**



11 Pour clean, warm water into the ice **Storage Bin** and melt any remaining ice. Remove **Agitator** and **Drip Ring**. Rinse the inside of the **Storage Bin, the Agitator, and Drip Ring** thoroughly with clean water.

Remove Front, Top Panels, and Bin Top

12 Pour clean, warm water over the **Extruding Head** until the **Evaporator Assembly** and the **Reservoir** are full and the water overflows into the **Drain Pan.**

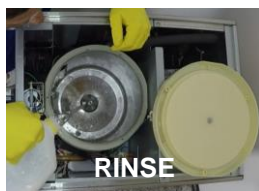

13 *Plug* the icemaker into the electrical outlet, then move the **power switch** to **ON**. Allow the icemaker to drain completely.



14 Move the **power switch** to **OFF**, then unplug the icemaker from the electrical outlet. Continue to **Sanitation – Step 15 on front...**

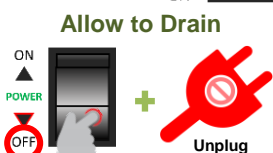

**! ATTENTION!**

**ENSURE ALL COMPONENTS, FASTENERS & THUMBSCREWS ARE SECURELY IN PLACE:**  
Make sure that none fall into the ice storage bin

**AMMONIA**  
Cleaners



DOWNLOAD COMPLETE INSTRUCTION MANUAL:



[hoshizakiamerica.com/manuals](http://hoshizakiamerica.com/manuals)

Type in the model number of your icemaker (including dashes) to download manuals

## CLEANING SCHEDULE

- **Air Filter** Dish soap, rinse well
  - **Water Filters** Check psi, change if req'd
  - **Exterior** Dish soap & damp cloth
  - **Pan/Gear Drain** Clear w/ warm water + brush
  - **Icemaker/Dispenser** Follow these instructions
  - **Water Supply Inlet** Clean inlet screen/valves
  - **Extruding Head** Inspect seal bolts/ bearing wear. Tighten or replace
  - **Water Hoses** Inspect. Replace if req'd
- **WEEKLY** | ● **MONTHLY** | ● **YEARLY**

**! ATTENTION!**

**DO NOT** use ammonia type cleaners. Can cause damage to icemaker

**WEAR** liquid-proof gloves and goggles to protect skin & eyes from cleaning & sanitizing chemicals

↓ sanitizing continued...

- Remove the front, top panels, and bin top **21**
- Pour clean, warm water into the ice storage bin to melt ice
- Plug the icemaker into the electrical outlet **22**
- Move **control switch** to DRAIN
- Move **power switch** to ON
- Allow to drain completely

- Move **power switch** to OFF **23**
- Unplug the icemaker

## SANITIZE 2: **24**

- Repeat Steps 15–23 for complete ice/food safety
- Move the **control switch** to ICE **25**
- Replace the front, top panels, and bin top
- Open the water supply line shut-off valve, to supply water back to the icemaker **26**
- Plug in the icemaker
- Move the **power switch** to ON
- Run icemaker for 30 minutes

- Move the **power switch** to OFF **27**
- Unplug the icemaker

- Remove the front, top panels, bin top, agitator, and drip ring **28**
- Wipe down the ice storage bin, bin top, agitator, drip ring, and drain pan with a clean cloth

- Move the **control switch** to ICE **29**
- Reassemble all items, replace all panels, and filter/louver

- Plug in the icemaker **30**
- Move **power switch** to ON