

# Hoshizaki America, Inc.

## Storage Bin

### Models

B-250PF

B-300PF

B-500PF

B-700PF

B-800PF

B-900PF



“A Superior Degree  
of Reliability”

[www.hoshizaki.com](http://www.hoshizaki.com)

## PARTS LIST



Number: 71213  
Issued: 12-17-2002

<b>B-300PF</b>	L-5	JUNE, 2001
	M-5	DEC., 2001
	N-5	DEC. 2002
<b>B-500PF</b>	L-5	JUNE, 2001
	M-5	DEC., 2001
	N-5	DEC. 2002
<b>B-700PF</b>	L-5	SEPT., 2001
	M-5	DEC., 2001
	N-5	DEC. 2002
<b>B-800PF</b>	L-5	SEPT., 2001
	M-5	DEC., 2001
	N-5	DEC. 2002
<b>B-900PF</b>	L-5	JUNE, 2001
	M-5	DEC., 2001
	N-5	DEC. 2002

## MATERIAL ABBREVIATIONS

### ALUMINUM

AL = Aluminum

### COPPER

CU = Copper

### PLASTIC

ABS = Acrylonitrile -butadiene - styrene  
 AC = Polyacetal  
 EVA = Ethylene vinyl acetate  
 PA = Polyamide = Nylon  
 PC = Polycarbonate  
 PE = Polyethylene  
 PES = Polyester  
 PETP = Polyethylene terephthalate = Tetlon  
 PP = Polypropylene  
 PS = Polystyrene  
 PTFE = Polytetrafluoroethylene = Teflon  
 PUR = Polyurethane  
 PVC = Polyvinyl chloride

### RUBBER

VN = Vinyl Nitrile  
 EPDM = EP rubber  
 NBR = Nitrile butadiene rubber  
 NR = Natural rubber  
 NP = Neoprene  
 SI.R = Silicone rubber  
 SY.R = Synthetic rubber  
 EPH = Epichlorohydrin

### STEEL

G.S = Galvanized steel  
 S.S = Stainless steel  
 PS = Plated steel  
 PAS = Primed steel

## AUXILIARY CODE

Ex.1

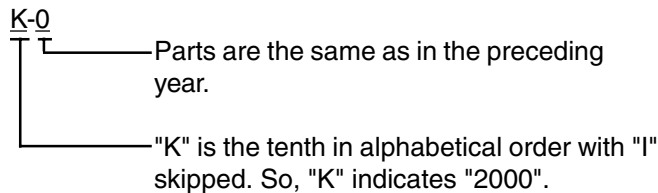

**(Note)** - = Part deleted.

x = Part deleted and replaced by "o" (interchangeable) part.

Ex.2

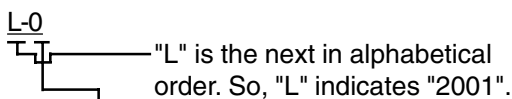

o = New part for "x" in the same auxiliary code.

Ex.3

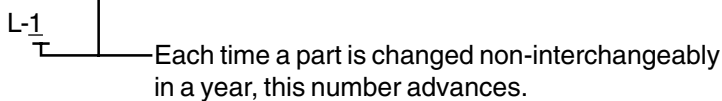

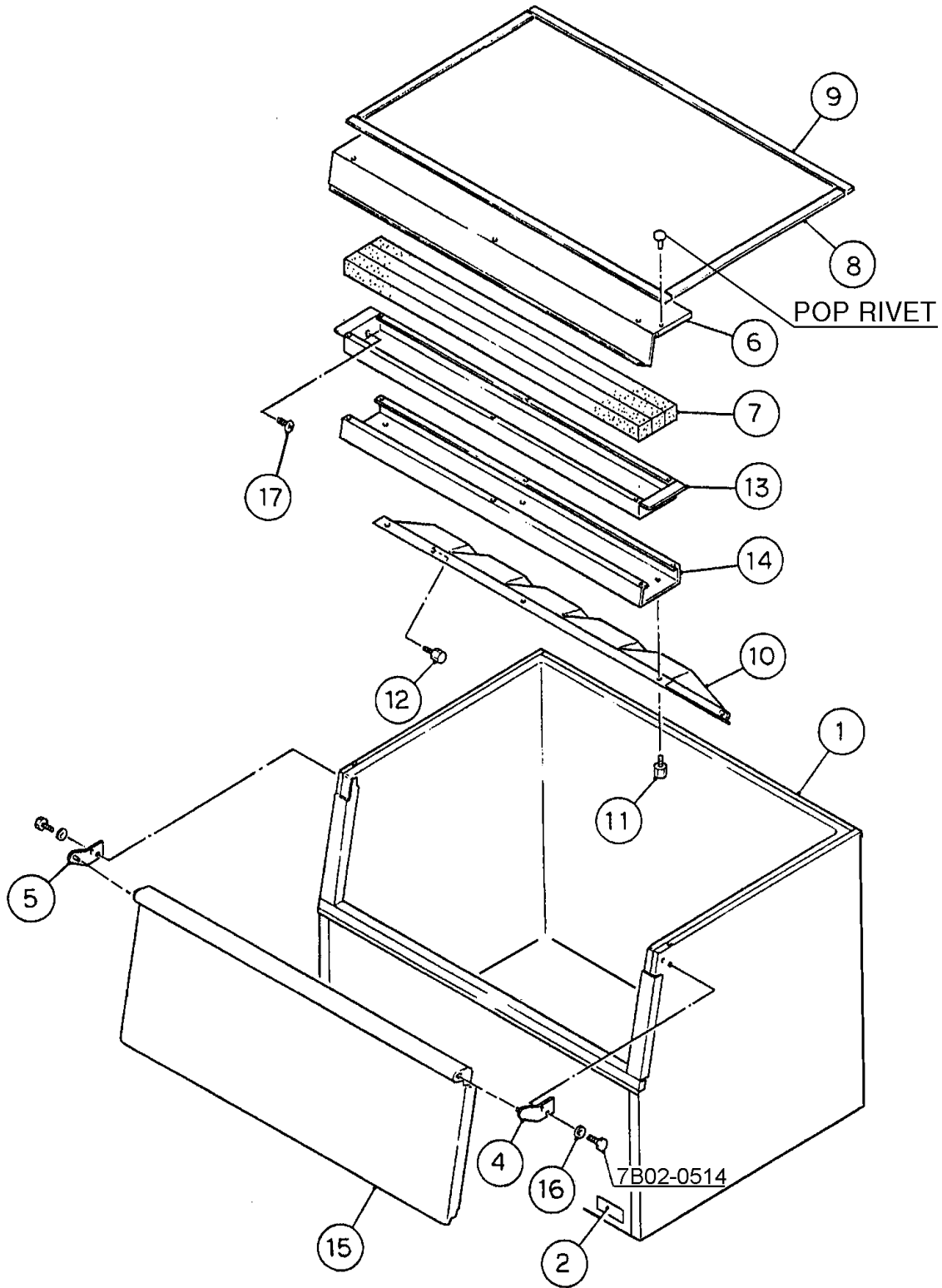

**MODEL: B-250PF    TITLE: A. BIN ASSEMBLY**

INDEX NO.	DESCRIPTION	MATERIAL OR MODEL NUMBER	PART NUMBER	REQUIRED NUMBER									
				L-5	M-5	N-5							
1	BIN BODY	-	1A0648A01	1	1	1							
2	NAMEPLATE	PES FILM	4A2580-01	1	1	1							
3	-	-	-										
4	HINGE-BODY(R)	SS	3A0105G01	1	1	1							
5	HINGE-BODY(L)	SS	3A0106G01	1	1	1							
6	TOP COVER(5)	SS	3A0157-01	1	1	1							
7	INSULATION(C3)	PS FORM	437687-02	3	3	3							
8	GASKET	PVC, L=630	4A0808L01	2	2	2							
9	GASKET	PVC, L=757	4A0808L01	2	2	2							
10	BAFFLE(5)	PS	104322-01	1	1	1							
11	THUMBSCREW	ABS,SS	415949G01	2	2	2							
12	THUMBSCREW	ABS,SS	434168G01	2	2	2							
13	FRONT FRAME	SS	3A0420-01	1	1	1							
14	FRONT FRAME COVER(5)	ABS	324625-01	1	1	1							
15	BIN DOOR	-	3A2087G05	1	1	1							
16	WASHER	SS	4A0198-01	4	4	4							
17	HEX HEAD TAPPING SCREW	#8, 3/4"	7B03I0834	2	2	2							

A. BIN ASSEMBLY

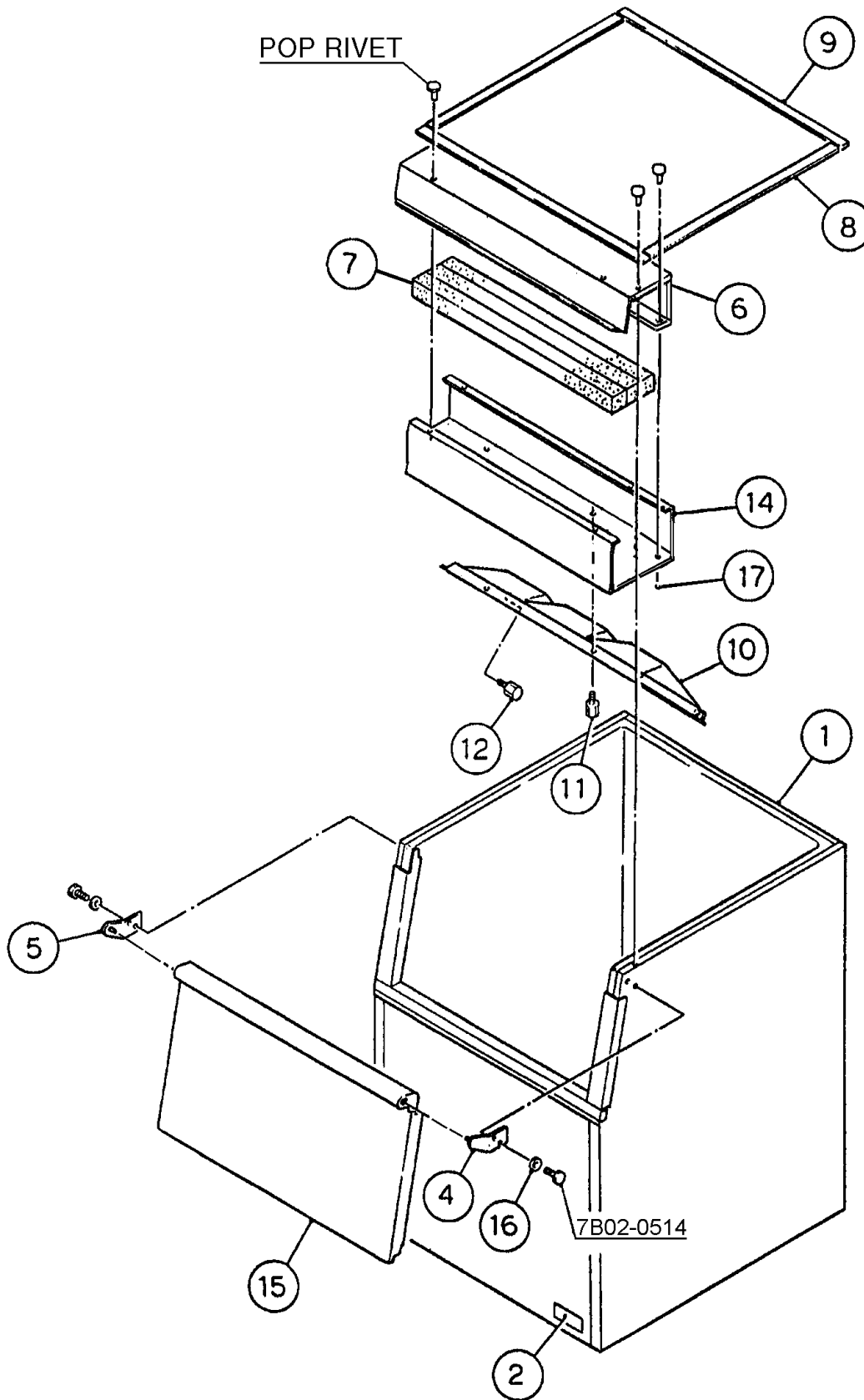

MODEL: **B-300PF** TITLE: **A. BIN ASSEMBLY**

INDEX NO.	DESCRIPTION	MATERIAL OR MODEL NUMBER	PART NUMBER	REQUIRED NUMBER									
				L-5	M-5	N-5							
1	BIN BODY	-	1A0648A02	1	1	1							
2	NAMEPLATE	PES FILM	4A2580-02	1	1	1							
3	-	-	-										
4	HINGE-BODY(R)	SS	3A0105G01	1	1	1							
5	HINGE-BODY(L)	SS	3A0106G01	1	1	1							
6	TOP COVER(3)	SS	3A0156-01	1	1	1							
7	INSULATION(C3)	PS FORM	437687-01	3	3	3							
8	GASKET	PVC, L=630	4A0808L01	2	2	2							
9	GASKET	PVC, L=554	4A0808L01	2	2	2							
10	BAFFLE(3)	PS	104391-01	1	1	1							
11	THUMBSCREW	ABS,SS	415949G01	2	2	2							
12	THUMBSCREW	ABS,SS	434168G01	2	2	2							
13	-	-	-										
14	FRONT FRAME COVER(3)	ABS	324617-01	1	1	1							
15	BIN DOOR	-	3A2087G04	1	1	1							
16	WASHER	SS	4A0198-01	4	4	4							
17	WASHER	-	4A0928-01	2	2	2							

A. BIN ASSEMBLY

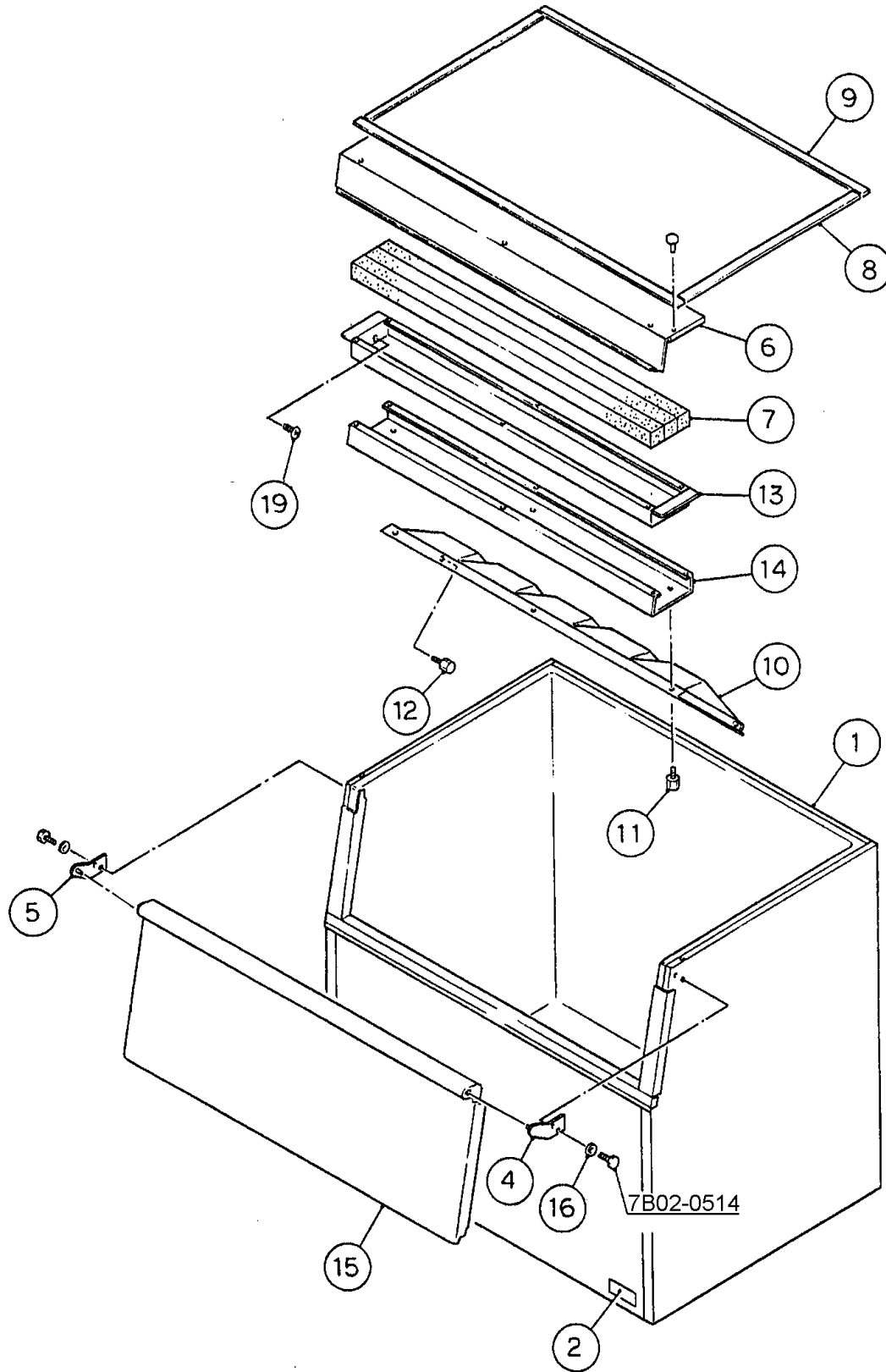



**MODEL: B-500PF TITLE: A. BIN ASSEMBLY**

INDEX NO.	DESCRIPTION	MATERIAL OR MODEL NUMBER	PART NUMBER	REQUIRED NUMBER													
				L-5	M-5	N-5											
1	BIN BODY	-	1A0648A04	1	1	1											
2	NAMEPLATE	PES FILM	4A2580-04	1	1	1											
3	-	-	-														
4	HINGE-BODY(R)	SS	3A0105G01	1	1	1											
5	HINGE-BODY(L)	SS	3A0106G01	1	1	1											
6	TOP COVER(5)	SS	3A0157-01	1	1	1											
7	INSULATION(C2)	PS FORM	437687-02	3	3	3											
8	GASKET	PVC, L=630	4A0808L01	2	2	2											
9	GASKET	PVC, L=757	4A0808L01	2	2	2											
10	BAFFLE(5)	PS	104322-01	1	1	1											
11	THUMBSCREW	ABS,SS	415949G01	2	2	2											
12	THUMBSCREW	ABS,SS	434168G01	2	2	2											
13	FRONT FRAME(5)	-	3A0420-01	1	1	1											
14	FRONT FRAME COVER(5)	ABS	324625-01	1	1	1											
15	BIN DOOR	-	3A2087G05	1	1	1											
16	WASHER	SS	4A0198-01	4	4	4											
17	-	-	-														
18	-	-	-														
19	HEX HEAD TAPPING SCREW	#8, 3/4"	7B03I0834	2	2	2											

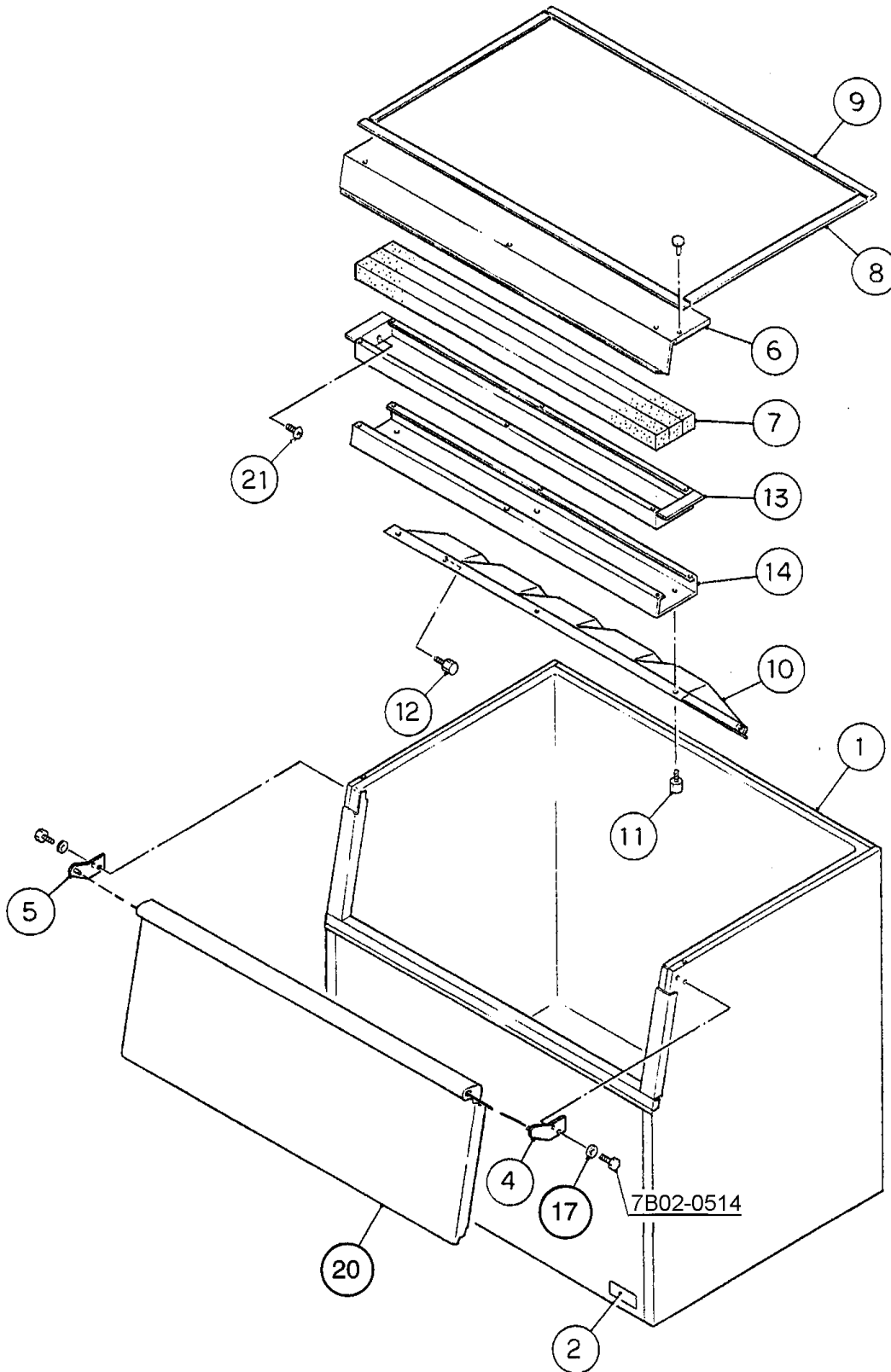

**MODEL: B-700PF TITLE: A. BIN ASSEMBLY**

INDEX NO.	DESCRIPTION	MATERIAL OR MODEL NUMBER	PART NUMBER	REQUIRED NUMBER																
				L-5	M-5	N-5														
1	BIN BODY	-	1A0648A06	1	1	1														
2	NAMEPLATE	PES FILM	4A2580-06	1	1	1														
3	-	-	-																	
4	HINGE-BODY(R)	SS	3A0105G01	1	1	1														
5	HINGE-BODY(L)	SS	3A0106G01	1	1	1														
6	TOP COVER(7)	SS	3A0158-01	1	1	1														
7	INSULATION(C7)	PS FORM	437687-03	3	3	3														
8	GASKET	PVC, L=630	4A0808L01	2	2	2														
9	GASKET	PVC, L=1112.5	4A0808L01	2	2	2														
10	BAFFLE(7)	PS	104323-01	1	1	1														
11	THUMBSCREW	ABS,SS	415949G01	3	3	3														
12	THUMBSCREW	ABS,SS	434168G01	2	2	2														
13	FRONT FRAME(7)	SS	3A0446-01	1	1	1														
14	FRONT FRAME COVER(7)	ABS	3A0155-01	1	1	1														
15	-	-	-																	
16	-	-	-																	
17	WASHER	SS	4A0198-01	4	4	4														
18	-	-	-																	
19	-	-	-																	
20	BIN DOOR	PE	3A2087G01	1	1	1														
21	HEX HEAD TAPPING SCREW	#8, 3/4"	7B03I0834	2	2	2														

**MODEL: B-800PF TITLE: A. BIN ASSEMBLY**

INDEX NO.	DESCRIPTION	MATERIAL OR MODEL NUMBER	PART NUMBER	REQUIRED NUMBER													
				L-5	M-5	N-5											
1	BIN BODY	-	1A0648A08	1	1	1											
2	NAMEPLATE	PES FILM	4A2580-08	1	1	1											
3	-	-	-														
4	HINGE-BODY(R)	SS	3A0105G01	1	1	1											
5	HINGE-BODY(L)	SS	3A0106G01	1	1	1											
6	TOP COVER(8)	SS	2A0106-01	1	1	1											
7	INSULATION(C8)	PS FORM	437687-05	3	3	3											
8	GASKET	PVC, L=630	4A0808L01	2	2	2											
9	GASKET	PVC, L=1316	4A0808L01	2	2	2											
10	BAFFLE(8)	PS	105012-01	1	1	1											
11	THUMBSCREW	ABS,SS	415949G01	4	4	4											
12	THUMBSCREW	ABS,SS	434168G01	2	2	2											
13	FRONT FRAME(8)	SS	3A0447-01	1	1	1											
14	FRONT FRAME COVER(8)	ABS	325510-01	1	1	1											
15	-	-	-														
16	-	-	-														
17	WASHER	SS	4A0198-01	4	4	4											
18	-	-	-														
19	-	-	-														
20	BIN DOOR	PE	3A2087G02	1	1	1											
21	HEX HEAD TAPPING SCREW	#8, 3/4"	7B03I0834	2	2	2											

**MODEL: B-900PF TITLE: A. BIN ASSEMBLY**

INDEX NO.	DESCRIPTION	MATERIAL OR MODEL NUMBER	PART NUMBER	REQUIRED NUMBER									
				L-5	M-5	N-5							
1	BIN BODY	-	1A0648A10	1	1	1							
2	NAMEPLATE	PES FILM	4A2580-10	1	1	1							
3	-	-	-										
4	HINGE-BODY(R)	SS	3A0105G01	1	1	1							
5	HINGE-BODY(L)	SS	3A0106G01	1	1	1							
6	TOP COVER(9)	SS	2A0107-01	1	1	1							
7	INSULATION(C9)	PS FORM	437687-04	3	3	3							
8	GASKET	PVC,L=630	4A0808L01	2	2	2							
9	GASKET	PVC,L=1316	4A0808L01	2	2	2							
10	BAFFLE(9)	PS	104324-02	1	1	1							
11	THUMBSCREW	ABS,SS	415949G01	4	4	4							
12	THUMBSCREW	ABS,SS	434168G01	2	2	2							
13	FRONT FRAME(9)	SS	3A0447-02	1	1	1							
14	FRONT FRAME COVER(9)	ABS	324619-01	1	1	1							
15	-	-	-										
16	-	-	-										
17	WASHER	SS	4A0198-01	4	4	4							
18	-	-	-										
19	-	-	-										
20	BIN DOOR	PE	3A2087G03	1	1	1							
21	HEX HEAD TAPPING SCREW	#8, 3/4"	7B03I0834	2	2	2							

MODEL: <b>B-300PF</b> TITLE: <b>B. ACCESSORIES</b>													
INDEX NO.	DESCRIPTION	MATERIAL OR MODEL NUMBER	PART NUMBER	REQUIRED NUMBER									
				L-5	M-5	N-5							
1	ADJUSTABLE LEG	-	4A2526-01	4	4	4							
2	INSTRUCTION SHEET/LEGS	PAPER	434803-01	1	1	1							
3	SCOOP	-	4A2246-01	1	1	1							
4	LEG PROTECTOR	-	3A0134-01	4	4	4							

MODEL: <b>B-250, 500, 700, 800, 900PF</b> TITLE: <b>B. ACCESSORIES</b>													
INDEX NO.	DESCRIPTION	MATERIAL OR MODEL NUMBER	PART NUMBER	REQUIRED NUMBER									
				L-5	M-5	N-5							
1	LEG	-	4A2525-01	4	4	4							
2	INSTRUCTION SHEET/LEGS	PAPER	434803-01	1	1	1							
3	SCOOP	-	4A2246-01	1	1	1							

MODEL: <b>B-250PF</b>				TITLE: <b>C. PACKAGING</b>									
INDEX NO.	DESCRIPTION	MATERIAL OR MODEL NUMBER	PART NUMBER	REQUIRED NUMBER									
				L-5	M-5	N-5							
	<b>PACKAGING</b>	-	<b>1A0649A01</b>	1	1	1							
1	PALLET	-	3A1829-02	1	1	1							
2	WOOD BLOCK B	-	4A0004-02	4	4	4							
3	SIDE PROTECTOR	-	4A2304-01	4	4	4							
4	CORNER POST	-	3A0782-01	4	4	4							
5	FOAM BLOCK – FRONT	-	4A0059-09	2	2	2							
6	CARTON	-	2A2010-07	1	1	1							
7	PACKAGE LABEL – F	-	4A2597-01	4	4	4							

MODEL: <b>B-300PF</b>				TITLE: <b>C. PACKAGING</b>									
INDEX NO.	DESCRIPTION	MATERIAL OR MODEL NUMBER	PART NUMBER	REQUIRED NUMBER									
				L-5	M-5	N-5							
	<b>PACKAGING</b>	-	<b>1A0649A02</b>	1	1	1							
1	PALLET	-	3A1829-01	1	1	1							
2	WOOD BLOCK B	-	4A0004-02	2	2	2							
3	SIDE PROTECTOR	-	4A2304-01	2	2	2							
4	CORNER POST	-	3A0782-02	4	4	4							
5	FOAM BLOCK – FRONT	-	4A0059-08	2	2	2							
6	CARTON	-	2A2010-02	1	1	1							
7	PACKAGE LABEL – F	-	4A2578-01	4	4	4							
8	WOOD BLOCK C	-	4A0004-03	2	2	2							
9	SIDE PROTECTOR	-	4A2304-03	2	2	2							

MODEL: <b>B-500PF</b>				TITLE: <b>C. PACKAGING</b>													
INDEX NO.	DESCRIPTION	MATERIAL OR MODEL NUMBER	PART NUMBER	REQUIRED NUMBER													
				L-5	M-5	N-5											
	<b>PACKAGING</b>	-	<b>1A0649A03</b>	1	1	1											
1	PALLET	-	3A1829-02	1	1	1											
2	WOOD BLOCK B	-	4A0004-02	4	4	4											
3	SIDE PROTECTOR	-	4A2304-01	4	4	4											
4	CORNER POST	-	3A0782-02	4	4	4											
5	FOAM BLOCK – FRONT	-	4A0059-08	2	2	2											
6	CARTON	-	2A2010-03	1	1	1											
7	PACKAGE LABEL – F	-	4A2578-01	4	4	4											

MODEL: <b>B-700PF</b>				TITLE: <b>C. PACKAGING</b>													
INDEX NO.	DESCRIPTION	MATERIAL OR MODEL NUMBER	PART NUMBER	REQUIRED NUMBER													
				L-5	M-5	N-5											
	<b>PACKAGING</b>	-	<b>1A0649A04</b>	1	1	1											
1	PALLET	-	3A1829-03	1	1	1											
2	WOOD BLOCK B	-	4A0004-02	4	4	4											
3	SIDE PROTECTOR	-	4A2304-01	4	4	4											
4	CORNER POST	-	3A0782-02	4	4	4											
5	FOAM BLOCK – FRONT	-	4A0059-08	2	2	2											
6	CARTON	-	2A2010-04	1	1	1											
7	PACKAGE LABEL – F	-	4A2578-01	4	4	4											



MODEL: <b>B-800PF</b>				TITLE: <b>C. PACKAGING</b>									
INDEX NO.	DESCRIPTION	MATERIAL OR MODEL NUMBER	PART NUMBER	REQUIRED NUMBER									
				L-5	M-5	N-5							
	<b>PACKAGING</b>	-	<b>1A0649A05</b>	1	1	1							
1	PALLET	-	3A1829-04	1	1	1							
2	WOOD BLOCK B	-	4A0004-02	4	4	4							
3	SIDE PROTECTOR	-	4A2304-01	4	4	4							
4	CORNER POST	-	3A0782-02	4	4	4							
5	FOAM BLOCK – FRONT	-	4A0059-08	2	2	2							
6	CARTON	-	2A2010-05	1	1	1							
7	PACKAGE LABEL – F	-	4A2578-01	4	4	4							

MODEL: <b>B-900PF</b>				TITLE: <b>C. PACKAGING</b>									
INDEX NO.	DESCRIPTION	MATERIAL OR MODEL NUMBER	PART NUMBER	REQUIRED NUMBER									
				L-5	M-5	N-5							
	<b>PACKAGING</b>	-	<b>1A0649A06</b>	1	1	1							
1	PALLET	-	3A1829-05	1	1	1							
2	WOOD BLOCK B	-	4A0004-02	4	4	4							
3	SIDE PROTECTOR	-	4A2304-01	4	4	4							
4	CORNER POST	-	3A0782-02	4	4	4							
5	FOAM BLOCK – FRONT	-	4A0059-08	2	2	2							
6	CARTON	-	2A2010-06	1	1	1							
7	PACKAGE LABEL – F	-	4A2578-01	4	4	4							